



BLUE BIRD

®

QuickRef

PARTS CATALOG FOR
SCHOOL BUSES **AND MORE!**

QuickRef

PARTS CATALOG FOR SCHOOL BUSES **AND MORE!**

Thank you for choosing Blue Bird...and Blue Bird parts!

As a seller of the most recognized and trusted brand in student transportation vehicles, your nearest **Blue Bird Authorized Dealer** is your best source for original equipment and aftermarket parts to keep your fleet in top shape. Your Blue Bird Dealer is staffed with true school bus parts experts; and the Parts and Service team at the Blue Bird home plant in Fort Valley, GA partners with industry leading component manufacturers to bring you top quality at competitively attractive prices.

Many of the leading-brand components used in the assembly of Blue Bird buses also occur in a broad range of medium duty truck applications, as well as other brand school buses. And that's what this catalog is all about. We hope you'll keep it handy as a quick lookup tool for many of the most frequently-needed replacement parts for your Blue Bird buses, other brand school buses, and even for other vehicles you may service in your facility.

Just browse the catalog for the Item To Order numbers you need, contact your Blue Bird Dealer for current pricing, and we'll take care of the rest.

Blue Bird's state-of-the-art Parts Distribution Center provides over 2.1 million cubic feet of clean, modern storage for over 40,000 items (and growing). And our business partnerships enable us to ship many more items to you directly from the manufacturers' warehouses, saving you time and money.

Of course it's not possible to list all our offerings in the **QuickRef** catalog. Be sure to contact your Blue Bird Dealer for all your maintenance, OE, and aftermarket parts needs. We welcome your input and look forward to serving you!



PARTS and SERVICE

© 2013-2016 Blue Bird Body Company. All rights reserved. No portion of this catalog, including text or images, may be reproduced by any means without the express written consent of the copyright holder. "Blue Bird" and the bird in flight logo are registered trademarks of Blue Bird Body Company.

All business names and logos used in this book are trademarks or registered trademarks of their respective holders. Some photos are provided by Blue Bird's Business Partners and are reproduced with their permission. All images are copyright of their respective holders.

Blue Bird Parts and Service relies upon its Business Partners for some of the information contained herein. Content is based upon information accurate at the time of publication and is subject to change without notice.

Espar

Engine Auxiliary Heaters

25.2823.25.0507.0Z
BOXED D5 E-GUARDIAN ASMBLY II - 12V



25.2824.72.1202.0Z
BOXED D12 E-GUARDIAN II ASMBLY 12V



25.2825.26.0500.0Z
BOXED D5E H-II E-GUARDIAN ASMBLY - 12V



Engine Auxiliary Heaters | Blowers

25.2434.99.1500.0Z
(Espar 25.2434.99.1500.0Z)
BLOWER / CONTROL UNIT 10KW M-II - 12V

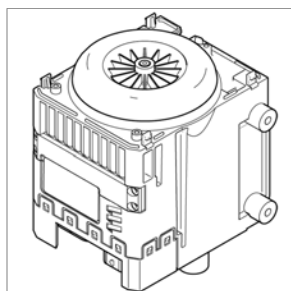

25.2472.99.1500.0Z
(Espar 25.2472.99.1500.0Z)
BLOWER / CONTROL UNIT 12KW M-II - 12V

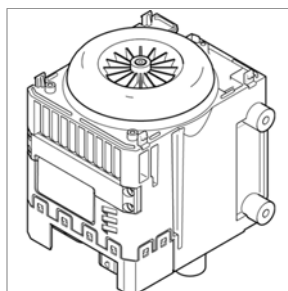

Engine Auxiliary Heaters | Combustion

25.2216.10.0000.2Z
(Espar 25.2216.10.0000.2Z)
BURNER D4/5 S+SC HYD

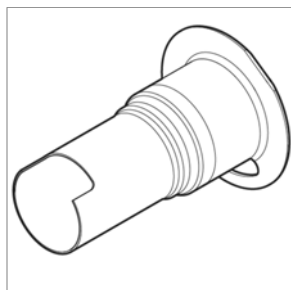

20.1820.99.0001.0Z
(Espar 20.1820.99.0001.0Z)
SEAL. BURNER D4/D5 HYDRONIC

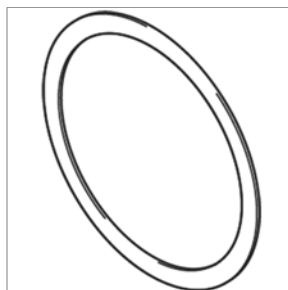

20.1819.99.1600.0Z
(Espar 20.1819.99.1600.0Z)
COMB BLOWER 12V B/D/4/5 S/SC

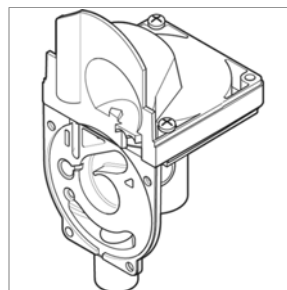

25.2106.01.1000.2Z
(Espar 25.2106.01.1000.2Z)
GLOW PIN W/CABLE B/D/4/5 12V

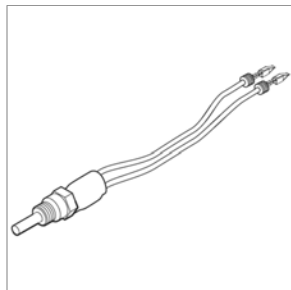

25.2121.99.0113.0Z
(Espar 25.2121.99.0113.0Z)
GLOW PIN LINING W/O RINGS D4/5



360.00.099
(Espar 360.00.099)
HOSE - 20MM APK COMB AIR

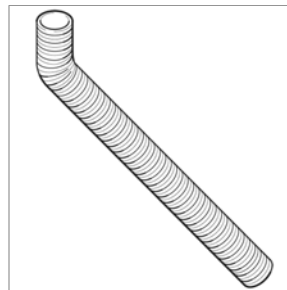

25.2435.99.1100.0Z
(Espar 25.2435.99.1100.0Z)
HYD M-II COMBUSTION BURNER

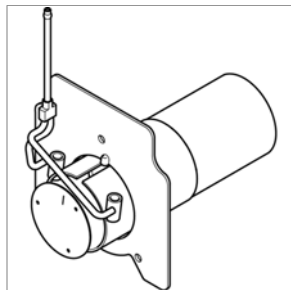

25.2435.01.0010.2Z
(Espar 25.2435.01.0010.2Z)
SEAL FOR COMBUSTION CHAMBER M-II

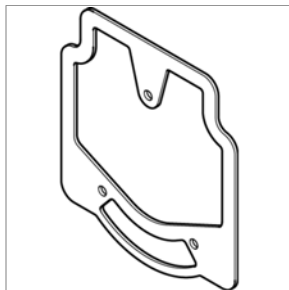

25.2434.01.0100.2Z
(Espar 25.2434.01.0100.2Z)
GLOW PIN HYDRONIC M-II 12V

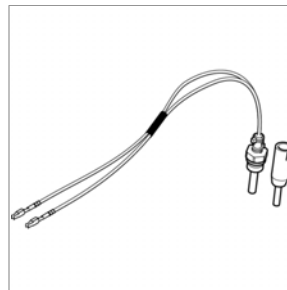

25.2069.10.0102.2Z
(Espar 25.2069.10.0102.2Z)
SCREEN FOR GLOW PIN D2/D4 AIR



25.1786.80.0200.0Z
(Espar 25.1786.80.0200.0Z)
AIR INT MUFFLER W/END CAP

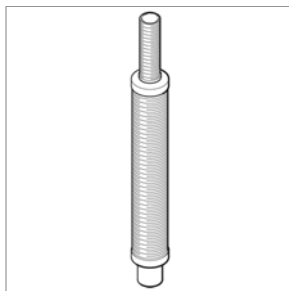

20.1643.01.0100.0Z
(Espar 20.1643.01.0100.0Z)
SPARK GENERATOR B3L/D12W

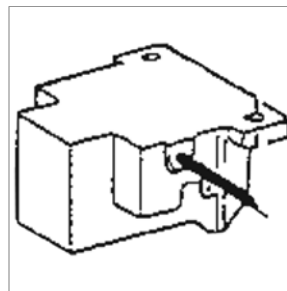

25.1996.99.0101.0Z
(Espar 25.1996.99.0101.0Z)
GLOW PIN 12V D9/10W



Engine Auxiliary Heaters | Control Modules

22.5201.04.0011.2Z
(Espar 22.5201.04.0011.2Z)
CONTROL UNIT D5 S+SC 2217/19

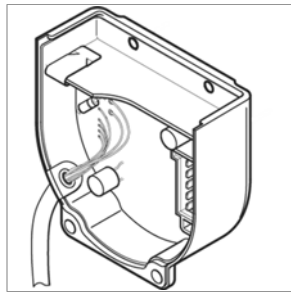

25.1688.50.0055.0Z
(Espar 25.1688.50.0055.0Z)
CONTROL UNIT D2H, D12W

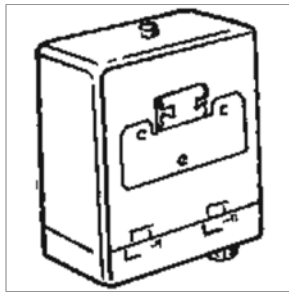

25.1570.52.0000.0Z
(Espar 25.1570.52.0000.0Z)
CONTROL UNIT 12V D12W1570/1655

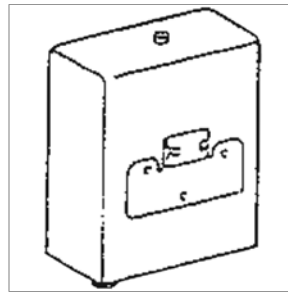

Engine Auxiliary Heaters | Exhaust

360.61.299
(Espar 360.61.299)
EXHAUST SS FLEX 2 LAYER 24MM ID / MTR

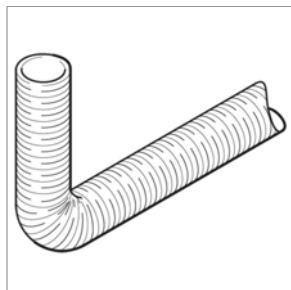

Engine Auxiliary Heaters | Fuel System

22.4517.04.0000.2Z
(Espar 22.4517.04.0000.2Z)
FUEL M. PUMP B/D5 (1820/2217/2325)

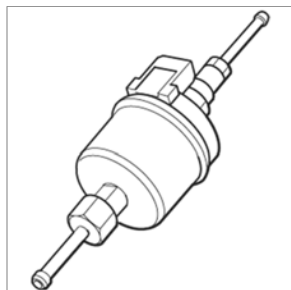

22.4504.03.0000.0Z
(Espar 22.4504.03.0000.0Z)
FUEL M.PUMP D4/5 12V 252257/19

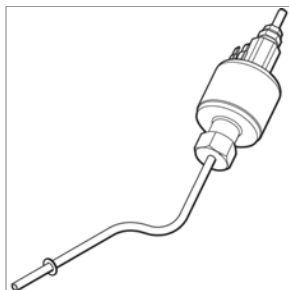

22.1000.50.0300.0Z
(Espar 22.1000.50.0300.0Z)
FMP HOLDER FOR NOISE REDUCTION

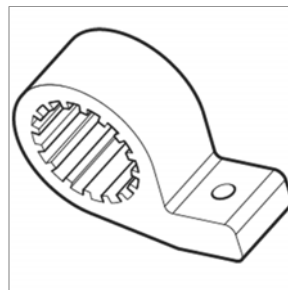

25.2435.01.0104.2Z
(Espar 25.2435.01.0104.2Z)
FUEL PIPE GROMMET M-II



22.4617.01.0000.0Z
(Espar 22.4617.01.0000.0Z)
METERING PUMP 12V

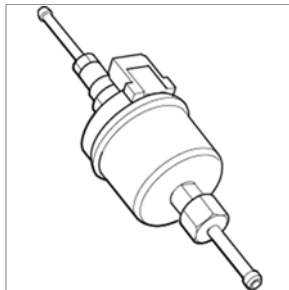

20.1312.00.0006.0Z
(Espar 20.1312.00.0006.0Z)
INTEGRATED FUEL FILTER

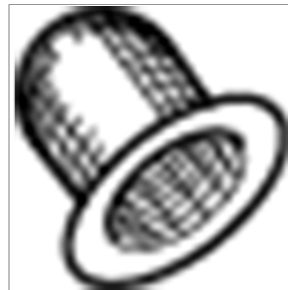

Engine Auxiliary Heaters | Hardware

22.1000.70.0009.0Z
(Espar 22.1000.70.0009.0Z)
O RING 7 X 2



22.1000.70.0006.0Z
(Espar 22.1000.70.0006.0Z)
O RING 14 X 2.6 COOLANT PUMP



22.1000.70.0015.2Z
(Espar 22.1000.70.0015.2Z)
O-RING 117.07 X 3.5 BLOWER M-II

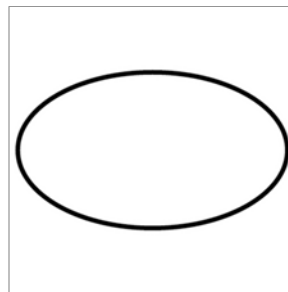

22.1000.70.0017.2Z
(Espar 22.1000.70.0017.2Z)
O-RING 19.8 X 2.3 WATERPUMP M-II

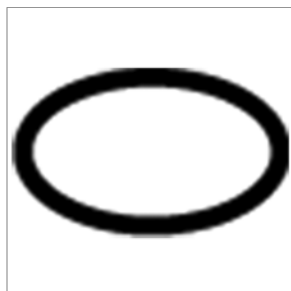

Engine Auxiliary Heaters | Housings

25.2435.99.0103.0Z
(Espar 25.2435.99.0103.0Z)
TOP COVER BLOWER HOUSING M-II

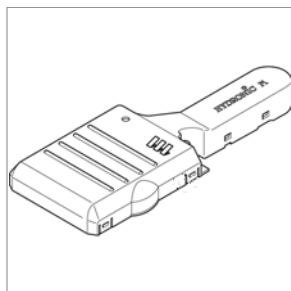

Engine Auxiliary Heaters | Pumps

25.2219.25.0000.2Z
(Espar 25.2219.25.0000.2Z)
COOLANT PUMP 12V B/D/4/5 SC

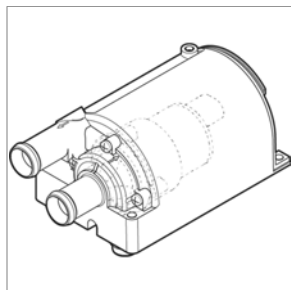

25.2434.99.2501.0Z
(Espar 25.2434.99.2501.0Z)
MII WATERPUMP 12V

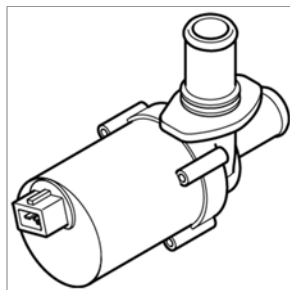

25.1815.25.0100.2Z
(Espar 25.1815.25.0100.2Z)
COOLANT PUMP 12V D9/D10W



25.2435.99.2501.0Z
(Espar 25.2435.99.2501.0Z)
WATERPUMP 24V - HYDRONIC M-II

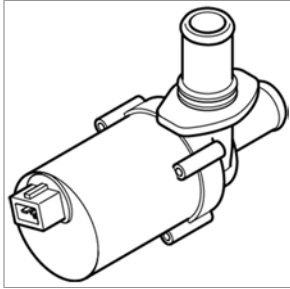

Your **Blue Bird Authorized Parts Dealer** is your one-stop resource for all the popular items featured in this catalog—and much more!

The parts you need; the brands you trust;
all at competitive prices from...

Your Blue Bird Authorized Parts Dealer



T E C H N I C A L P U B L I C A T I O N S

Post Office Box 937 • Fort Valley, Georgia 31030, USA • www.blue-bird.com