



BLUE BIRD

®

QuickRef

PARTS CATALOG FOR
SCHOOL BUSES **AND MORE!**

QuickRef

PARTS CATALOG FOR SCHOOL BUSES **AND MORE!**

Thank you for choosing Blue Bird...and Blue Bird parts!

As a seller of the most recognized and trusted brand in student transportation vehicles, your nearest **Blue Bird Authorized Dealer** is your best source for original equipment and aftermarket parts to keep your fleet in top shape. Your Blue Bird Dealer is staffed with true school bus parts experts; and the Parts and Service team at the Blue Bird home plant in Fort Valley, GA partners with industry leading component manufacturers to bring you top quality at competitively attractive prices.

Many of the leading-brand components used in the assembly of Blue Bird buses also occur in a broad range of medium duty truck applications, as well as other brand school buses. And that's what this catalog is all about. We hope you'll keep it handy as a quick lookup tool for many of the most frequently-needed replacement parts for your Blue Bird buses, other brand school buses, and even for other vehicles you may service in your facility.

Just browse the catalog for the Item To Order numbers you need, contact your Blue Bird Dealer for current pricing, and we'll take care of the rest.

Blue Bird's state-of-the-art Parts Distribution Center provides over 2.1 million cubic feet of clean, modern storage for over 40,000 items (and growing). And our business partnerships enable us to ship many more items to you directly from the manufacturers' warehouses, saving you time and money.

Of course it's not possible to list all our offerings in the **QuickRef** catalog. Be sure to contact your Blue Bird Dealer for all your maintenance, OE, and aftermarket parts needs. We welcome your input and look forward to serving you!



PARTS and SERVICE

© 2013-2016 Blue Bird Body Company. All rights reserved. No portion of this catalog, including text or images, may be reproduced by any means without the express written consent of the copyright holder. "Blue Bird" and the bird in flight logo are registered trademarks of Blue Bird Body Company.

All business names and logos used in this book are trademarks or registered trademarks of their respective holders. Some photos are provided by Blue Bird's Business Partners and are reproduced with their permission. All images are copyright of their respective holders.

Blue Bird Parts and Service relies upon its Business Partners for some of the information contained herein. Content is based upon information accurate at the time of publication and is subject to change without notice.

Roush®

Fuel System | Decals, Markings

D85
(Roush® D85)
DIAMOND PROPANE-REFLECTIVE (TAILGATE)



P11BB-01A020-AA
HANG TAG



P07L3-9A095-CA
(Roush® P07L3-9A095-CA)
LABEL-BLEEDER VALVE INSPECTION



P07L3-9A095-AA
(Roush® P07L3-9A095-AA)
LABEL-PROPANE FUEL ONLY



P07L3-9A095-IC
(Roush® P07L3-9A095-IC)
LABEL, 350 PSIG DESIGN PRESSURE



P11BB-9C076-AB
(Roush® P11BB-9C076-AB)
LABEL, FUEL TANK INFORMATION



P11BB-01C200-BA
(Roush® P11BB-01C200-BA)
LABEL, OVERFILL PROTECTION DEVICE



Fuel System | Engine Accessories

P11BB-8620-BA
(Roush® P11BB-8620-BA)
BELT, MAIN SHEAVE NON-A/C

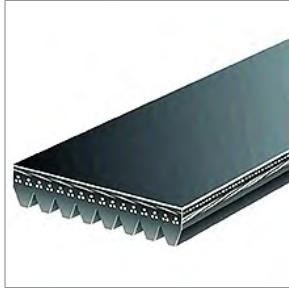

10023178
(Roush® P11BB-8620-AA)
BELT, ENGINE, WITH A-C, FORD P11BB-8620-AA

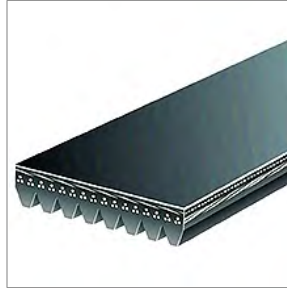

P11BB-19N589-BB
(Roush® P11BB-19N589-BB)
BRACKET, A/C COMPRESSOR



P11BB-6750-AA
DIPSTICK, ENGINE OIL



10019473-G
ENGINE CROSS MEMBER



2C2E-19A216-AB
(Roush® 2C2E-19A216-AB)
IDLER, ACCESSORY DRIVE



7R3V-19A216-AA
(Roush® 7R3V-19A216-AA)
IDLER, ACCESSORY DRIVE



7C34-5A262-HA
(Roush® 7C34-5A262-HA)
ISOLATOR, EXHAUST, MUFFLER, FORD PROPANE



P11BB-6C254-AA
(Roush® P11BB-6C254-AA)
PULLEY ASSY, CRANKSHAFT, EXTN, FORD



P11BB-9B464-AA
(Roush® P11BB-9B464-AA)
PULLEY, 2ND SHEAVE AIR PUMP DRIVE



P11BB-3D673-AA
(Roush® P11BB-3D673-AA)
PULLEY, POWER STEERING PUMP



10017446
(Roush® P11BB-03E021-AA)
PUMP ASSY, POWER STEERING, GM 8.1 PROPANE



2L3E-6B209-AB

(Roush® 2L3E-6B209-AB)
TENSIONER - 1ST SHEAVE W/O AC

**7R3V-6B209-AA**

(Roush® 7R3V-6B209-AA)
TENSIONER, 2ND SHEAVE

**P11BB-6K873-BA**

(Roush® P11BB-6K873-BA)
TUBE, ENGINE OIL DIPSTICK

**Fuel System | Fasteners****N806184-S437**

(Roush® N806184-S437)
BOLT, M8 X 1.25 X 113.5 HEX FLANGE 9

**69427**

(Roush® 69427)
DOWEL PIN, 10MM

**11-031-0602**

(Roush® 11-031-0602)
M5 DUST COVER KNOB 10028901

**W714403-S437**

(Roush® W714403-S437)
STUD, M8 X 1.25 X 103 & M6 X 1 X 13 HEX FLANGE 8

**Fuel System | Filters****P11BB-9155-AB**

(Roush® P11BB-9155-AB)
FILTER ASSY, FUEL FILL

**2C5Z-9155-BC**

(Roush® 2C5Z-9155-BC)
FILTER, IN LINE FUEL



Fuel System | Fuel Rails

HO-118SS
(Roush® HO-118SS)
CLIP, C STYLE INJECTOR RETENSION

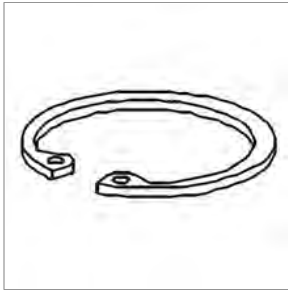

P11BB-9F899LH-AE
(Roush® P11BB-9F899LH-AE)
FUEL INJECTOR RAIL SYSTEM - LH



P11BB-9F899RH-AF
(Roush® P11BB-9F899RH-AF)
FUEL INJECTOR RAIL SYSTEM, RH



P11BB-03D021-AA
(Roush® P11BB-03D021-AA)
FUEL INJECTOR, DEKA II



P10C3-9G756-AA
(Roush® P10C3-9G756-AA)
FUEL IPTS - 10K OHM THERMISTOR



P11BB-9F913LH-AD
(Roush® P11BB-9F913LH-AD)
FUEL RAIL, LH 6.8L 3V



P11BB-9F913RH-AE
(Roush® P11BB-9F913RH-AE)
FUEL RAIL, RH 6.8L 3V



P11BB-03D023-BA
SPACER, FUEL INJECTOR



Fuel System | Hose, Line Assemblies

P-10D124-B-1766
FUEL FILL LINE, 45 X STRAIGHT

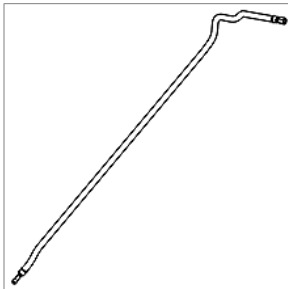

P-10D121-C-436
FUEL FILL LINE, 90 X STRAIGHT 10023470

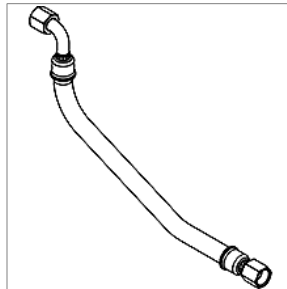

P11BB-9E965-AF
FUEL LINE ASSEMBLY RETURN

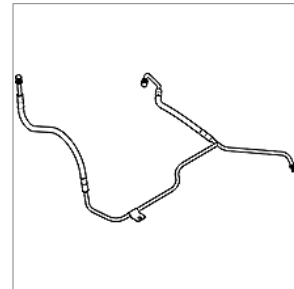

P11BB-9F911-AA
(Roush® P11BB-9F911-AA)
FUEL LINE, FORWARD SUPPLY



P11BB-9E964-AA
FUEL RAIL SUPPLY ASSEMBLY

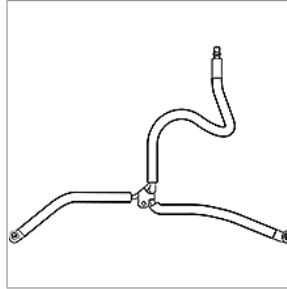

P11BB-9D676-AD
(Roush® P11BB-9D676-AD)
HOSE ASSY, CANISTER PURGE LINE



P11BB-9K313-AB
(Roush® P11BB-9K313-AB)
HOSE ASSY, FUEL VAPOR DISTRIBUTION



Fuel System | Modules

10020183
(Roush® P13EB-10E200-AA)
MODULE,ELECTRICAL,FRPCM,FORD 6.8L,BBCV



P11BB-03P200-AC
(Roush® P11BB-03P200-AC)
SMART RELAY MODULE 10019807



Fuel System | Pumps

P11GD-10A061-AB
(Roush® P11GD-10A061-AB)
COVER PLATE, FUEL TANK



P12GD-9H307-AD
(Roush® P12GD-9H307-AD)
FUEL PUMP ASSEMBLY



P11GD-18K277-AB
(Roush® P11GD-18K277-AB)
WIRE HARNESS, IN TANK

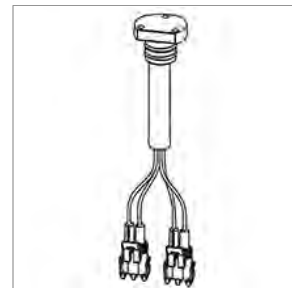

Fuel System | Relays

AA8A-9D412-CA
(Roush® AA8A-9D412-CA)
ELECTRIC FUEL PUMP RELAY



Fuel System | Seals

N0299-50-2-108
(Roush® N0299-50-2-108)
O-RING 0.237" ID 0.103" X-SECT



22S-S04
(Roush® 22S-S04)
O-RING PLUG



568-357-VT75
(Roush® 568-357-VT75)
O-RING, 5-1/2 ID X .210" VITON

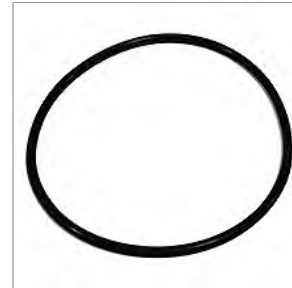

N0756-75-2-203
(Roush® N0756-75-2-203)
O-RING, NBR .296ID X .139C-S



N0756-75-2-128
(Roush® N0756-75-2-128)
O-RING, NBR 1.487"ID X .103 C/S

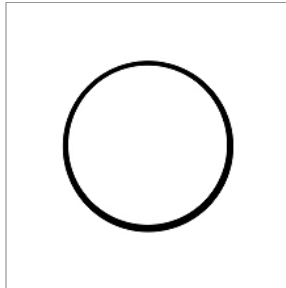

Fuel System | Sensors, Senders

P-10A609-AA
DIAL FUEL SEND



P11BB-10A614-AA
(Roush® P11BB-10A614-AA)
FUEL SENDER ASSY, 14" TANK



Fuel System | Valves | Propane

661161
(Roush® 661161)
BLEEDER NOZZLE



1850-10
(Roush® 1850-10)
CAP, FILL, VALVE PV1855BRCN



P11BB-9C375-AD
(Roush® P11BB-9C375-AD)
FUEL RETURN CIRCUIT ASSEMBLY



P11GD-10A100-AB
(Roush® P11GD-10A100-AB)
FUEL SUPPLY CIRCUIT ASSEMBLY



S-P-01K002-AA
(Roush® S-P-01K002-AA)
GEN 3 FUEL PRESSURE SERVICE TOOL ASY



P11BB-10G230-AB
(Roush® P11BB-10G230-AB)
OUTLET NOZZLE ASSEMBLY



P11BB-10G100-AA
(Roush® P11BB-10G100-AA)
PRESSURE RELIEF OUTLET



66-1157
(Roush® 66-1157)
VALVE ASSEMBLY, FUEL FILL



PV1855BRCN
(Roush® PV1855BRCN)
VALVE, LPG FILL



P11BB-9E857-AC
(Roush® P11BB-9E857-AC)
VAPOR CANISTER & BRACKET ASSEMBLY



Your **Blue Bird Authorized Parts Dealer** is your one-stop resource for all the popular items featured in this catalog—and much more!

The parts you need; the brands you trust;
all at competitive prices from...

Your Blue Bird Authorized Parts Dealer



T E C H N I C A L P U B L I C A T I O N S

Post Office Box 937 • Fort Valley, Georgia 31030, USA • www.blue-bird.com